

670' linear feet of
shoreline in applic

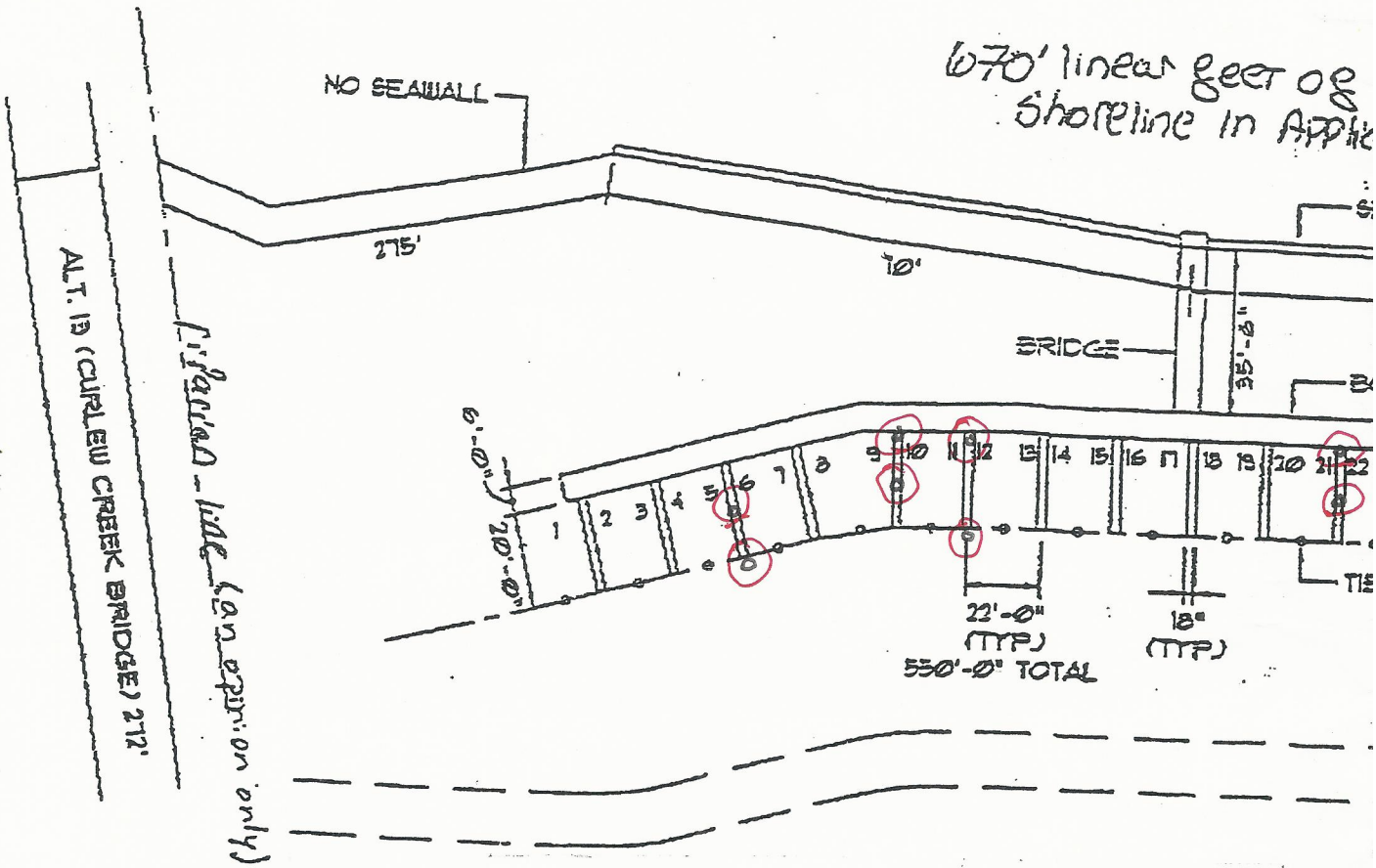

I certify that I have reviewed the structure described on these plans and determined that they have been designed to be in compliance with the structural requirements of the FBC 2010. No mechanical, electrical or plumbing components are included in this certification.

Paul E. Hagler, FPE 20158, 1280 Heather Ridge Boulevard,
Dunedin, FL 34698 727-738-9025



PARTIAL SITE PLAN

NTS.

FILE NAME: 1009/

nts_ownership

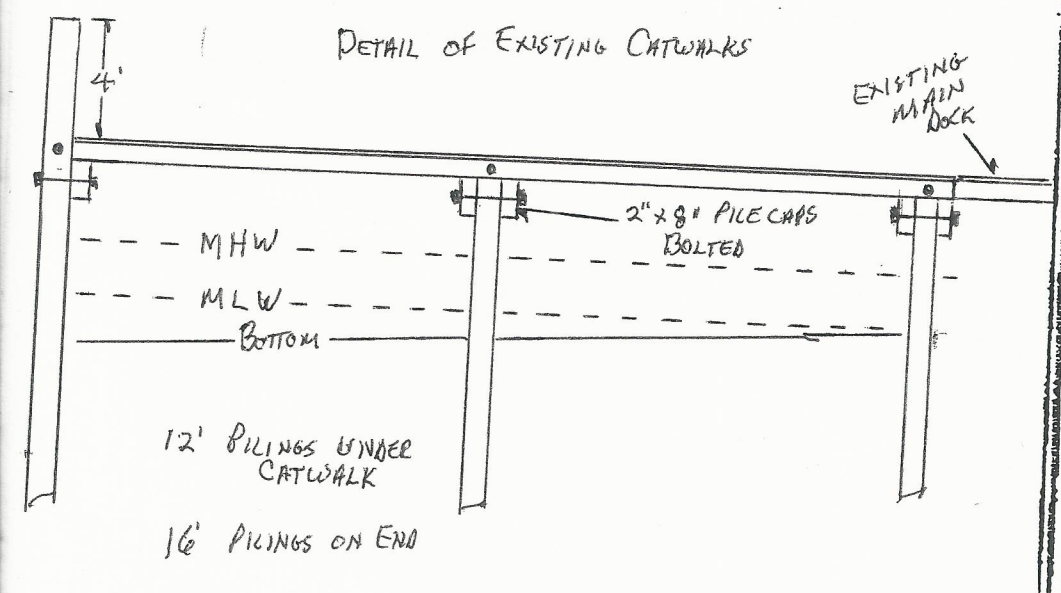
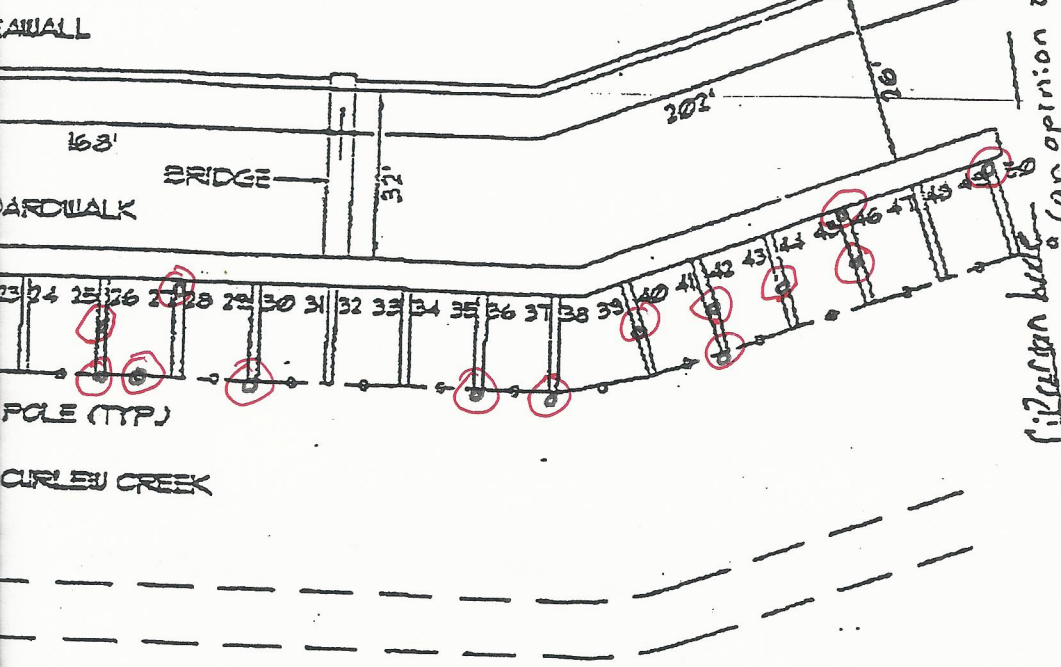

Attachment A
 Page 9 of 9 Pages
 SSSL No. 570029964
 2

SCHEMATIC LAYOUT FOR:
**CURLEW LANDINGS
 DOCK ASSOCIATION**

DATE
 6-25-99

PROJECT NO.
 1009

SHEET NO.
 SKE-1